



# KAOKO™ CRUISE CONTROL KITS : BUB

For **BUELL**  
Models **XB12X Ulysses, XB12Ss, XB12S & XB12R**



Patents  
"U.S. Pat. No. US D593,462 S"  
"U.S. Pat. No. US D593,463 S"  
"U.S. Pat. No. US D593,464 S"

RSA Registered Designs  
No. A2007/00202 No. A2007/00205  
No. A2007/00203 No. A2007/00206  
No. A2007/00204 No. A2007/00207

Friction Nut and grub screw - 2mm Allen Key

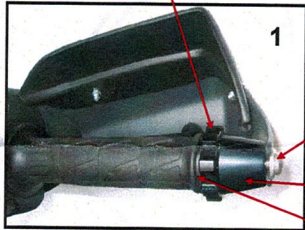

Ulysses Model

Central Retaining Screw with washer

Throttle RH Bar Weight Body with Thrust Washer

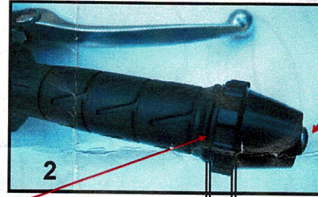

1mm

Central Retaining Screw No washer

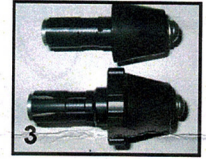

Left Hand Bar weight and Right Hand Throttle Control

**DISCLAIMER: NO RESPONSIBILITY ACCEPTED FOR NON-ADHERENCE TO THESE INSTRUCTIONS**

## KAOKO™ Safety Warning:

See: [www.kaoko.com](http://www.kaoko.com) for further information [info@kaoko.com](mailto:info@kaoko.com)

The KAOKO™ Cruise Control is an aftermarket accessory. Any misunderstood, abused or incorrectly installed motorcycle accessory is a safety hazard that could cause injury or death. It's the rider's responsibility to understand the operation and purpose for which the KAOKO™ Cruise Control is designed, namely, for cruising, only when safe to do so. At all other times the control should be disengaged. The KAOKO™ Cruise Controls are to be used only by experienced and responsible riders.

**Note:** An adjustment to throttle assembly position may be necessary to suit KAOKO™ Cruise Controls. The throttle assembly position on aftermarket bars, and some OEM bars, is adjustable. The assembly can marginally be re-positioned along the handle bars slightly loosening the throttle assembly clamp screws, and then sliding the throttle assembly along the handle bars (left or right). Once done, firmly tighten the clamp screws to OEM torque specifications. This adjustment is generally not necessary.

## Fitting & Operating Instructions:

**Step 1:** For the above models, the OEM plastic plugs must be pulled out of each end of the handle bar in order to fit the KAOKO™ Kit (No dismantling of hand grips is necessary). For the Ulysses model, install kit typically as shown in picture 1 & for non-hand guard models, install typically per picture 2. Note that the 8mm washers are not required in this case (picture 2)

**Step 2:** Fully insert LHS Bar Weight into handle bar end and firmly tighten the central retaining screw (5mm Allen Key). Retighten after first few rides.

**Step 3:** Fully insert Throttle Control Kit (RHS) with the thrust washer similarly as described per step 2.

**Note:** Set the position of Friction Nut with 1mm gaps on each side of friction nut (per picture 2) before tightening central retaining screw.

**Step 4:** Back off the Friction Nut against body of Bar Weight to disengage the Throttle Control. **VERY IMPORTANT!!** -- The throttle should open and snap closed freely when correctly disengaged.

**Step 5:** Set Friction Nut to the desired resistance by gently tightening the grub screw with 2mm Allen key. The friction nut should be stiff turning. See picture 2.

**Operation:** The friction nut has a **left hand thread**. In readiness for engagement it must be adjusted so that it makes light contact with the throttle sleeve.

**To Engage:** Whilst rolling on the throttle, the friction nut can be gripped between the small finger and palm of hand. This action tightens the nut and provides sufficient friction to set throttle to the desired opening.

*(The friction is such that the rider may still open and close the throttle. The throttle simply has a slight rotational stiffness.)*

**To Disengage:** Whilst rolling off the throttle, grip friction nut between small finger and palm of hand.

**VERY IMPORTANT!! The throttle should open and snap closed freely when correctly disengaged.**

**Note:** The Grub Screw (see picture 2) is set to provide the necessary rotational resistance on the thread of the friction nut. This may be adjusted periodically to take up wear.

**Maintenance:** Wash with soapy water regularly (no acid based cleaning materials) and apply silicone based car polish to surfaces. Check that the central screws are tight. Remove kit annually. Unscrew friction nut and brush clean threads with mild soap. Apply petroleum jelly to threads and assemble. Adjust grub if necessary.

**Note:** The Grub Screw is set to provide the necessary resistance on thread of friction nut. The nut should have firm rotational resistance to be correct. The nut should be stiff turning. (Use 2mm Allen key)

(O-Ring cushion: 19.6 mm I.D. x 2.4 mm section — if replacement is required).

## Indemnity:

It is advised that the use of the cruise control is at the sole risk of the rider and by his/her decision to use it he/she does indemnify the manufacturers or organizers, their agents, employees and officers against any claim or action by themselves, their dependents or any other third party arising out of any loss, damage, injury or death suffered.

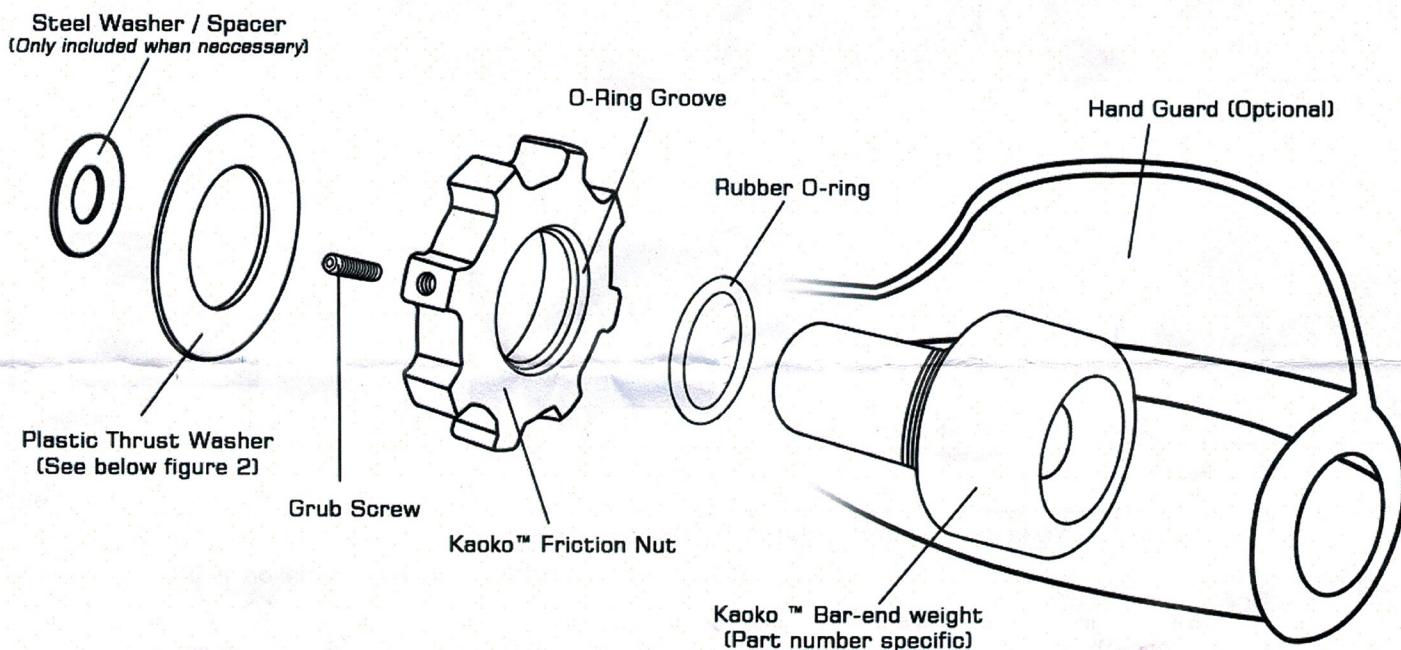
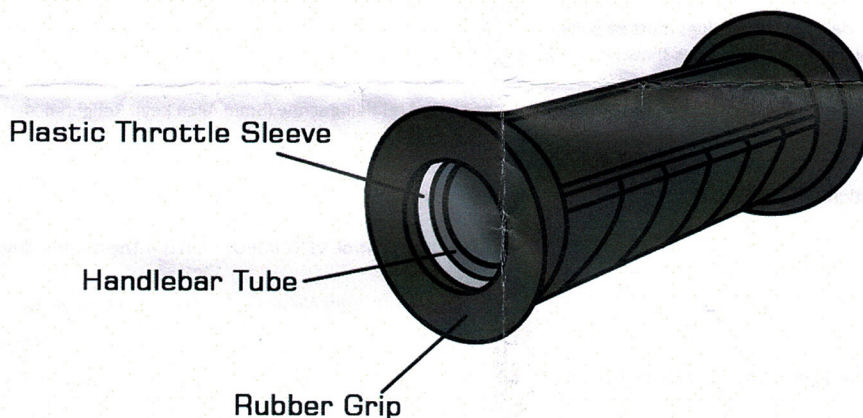

Figure 2: Thrust Washer Final Fitment

Note: The KAOKO™ Thrust Washer (ref: figure 1) must thrust against the plastic throttle sleeve (tube) indicated below in figure 2.

The KAOKO™ Thrust Washer must not thrust against the rubber throttle grip. Refer detailed instructions on reverse.



KAOKO™ ACCESSORIES AND PRODUCTS

Express Disclaimer, Exclusion of Liability, Indemnity and Safety Warning:

1. The accessories and products supplied by KAOKO™ are aftermarket accessories and products.
2. The use and employment of such accessories and products is at the sole risk and discretion of the user.
3. The user of such accessories and products further indemnifies KAOKO™ and its representatives against all claims and losses arising (including personal injuries, death, damage to property and any other losses) and involving such accessories and products.
4. KAOKO™ provides no warranty on accessories and products that it produces and distributes and does not aver that these accessories and products are fit for the purposes for which same are manufactured and intended.
5. KAOKO™ assumes no responsibility for and liability regarding any and all defects, deficiencies or otherwise in and attributed to its motor accessories and products.
6. KAOKO™ further assumes no responsibility for and liability regarding any prospective losses and claims for damages; be same actual, consequential or contingent and which in any way are associated with its motor accessories and products. In circumstances where accessories and products supplied are found to be of defective manufacture, KAOKO™ reserves its rights to replace such defective accessories and products, alternatively; effect a financial refund equivalent to the purchase price of such accessories and products as at the date of placement of order.
7. The application and affixing of KAOKO™ accessories and products to vehicles may necessitate or result in modifications being undertaken and this may result in manufacturer or otherwise warranties provided on such vehicles being affected and for that matter voided. In circumstances where the above occurs, KAOKO™ expressly denies being accountable regarding any liability and losses ensuing.
8. The application and affixing of KAOKO™ accessories and products may further result in usual vehicle operations and safety features being modified, override and for that matter discarded.
9. KAOKO™ accessories and products ought to be used by experienced and responsible riders only. The onus rests on the user of such KAOKO™ accessories and products to become properly familiarised with and understand the nature, operation and scope of the above accessories and products and further ensure that same are correctly affixed and used at all times and further not abused.
10. Misapplication and abuse of such accessories and products can endanger the user and result in injury or death and further constitute safety hazards.
11. The affixing and usage advices provided by KAOKO™ are for guidance purposes only and do not constitute specific fitment instructions. The onus rests on the user to ascertain and ensure proper and professional affixing and fitting to vehicles of the accessories and products and in seeking suitably qualified assistance in dealing with the above.
12. Prior to resorting to using KAOKO™ accessories and products, it is recommended that the user seek independent advice regarding the integrity and suitability of above accessories and products and in fulfilling the user's needs.
13. KAOKO™ accessories and products should only be fitted to new motorcycles and those that are in original condition, having not been involved in any accidents, being dropped, damaged or the subject of repair. Where KAOKO™ accessories and products are fitted to motorcycles not in original condition there is the risk that the operation of KAOKO™ accessories and products will be compromised and damaged. In all of the above events, KAOKO™ does not accept liability.