



## Driving Light Mount KTM 790 Adventure/R LAH.04.10200



### Thank you for choosing DENALI

We know you would rather be riding your bike than wrenching on it, so we go the extra mile to make sure our instructions are clear and as easy to understand as possible. If you have any questions, comments, or suggestions don't hesitate to give our gear experts a call at 401.360.2550 or visit WWW.DENALIELECTRONICS.COM

### Please Read Before Installing

DENALI products should always be installed by a qualified motorcycle technician. If you are unsure of your ability to properly install a product, please have the product installed by your local motorcycle dealer. DENALI takes no responsibility for damages caused by improper installation. **Caution:** When installing electronics it is extremely important to pay close attention to how wires are routed, especially when mounting products to the front fender, front forks, or fairing of your motorcycle. Always be sure to turn the handlebars fully left, fully right, and fully compress the suspension to ensure the wires will not bind and have enough slack for your motorcycle to operate properly.

### Installation Tips

We strongly recommend using medium strength liquid thread locker on all screws, nuts, and bolts. It is also important to ensure that all hardware is tightened to the proper torque specifications as listed in your owner's manual. For included accessory hardware please refer to the default torque specifications provided below. Inspect all hardware after the first 30 miles to ensure proper torque specifications are maintained.

Bolt Size	in-lbs	ft-lbs	Nm
M3	10.0 in-lbs	-	1.0 Nm
M4	23.0 in-lbs	-	2.5 Nm
M5	44.5 in-lbs	3.5 ft-lbs	5.0 Nm
M6	78.0 in-lbs	6.5 ft-lbs	9.0 Nm
M8	-	13.5 ft-lbs	18.0 Nm
M10	-	30.0 ft-lbs	41.0 Nm
M12	-	52.0 ft-lbs	71.0 Nm

### Hardware Sizing Guide

Not sure what size bolt you have? Use this ruler to measure screws, bolts, spacers, etc. Remember, the length of a screw or bolt is measured from the start of the "mounting surface" to the end of the screw, so only include the screw head when measuring countersunk screws.

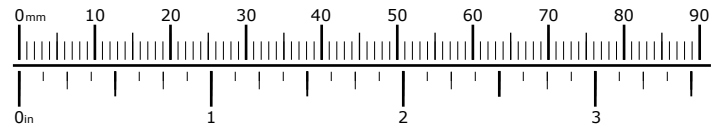

## What's In The Box?

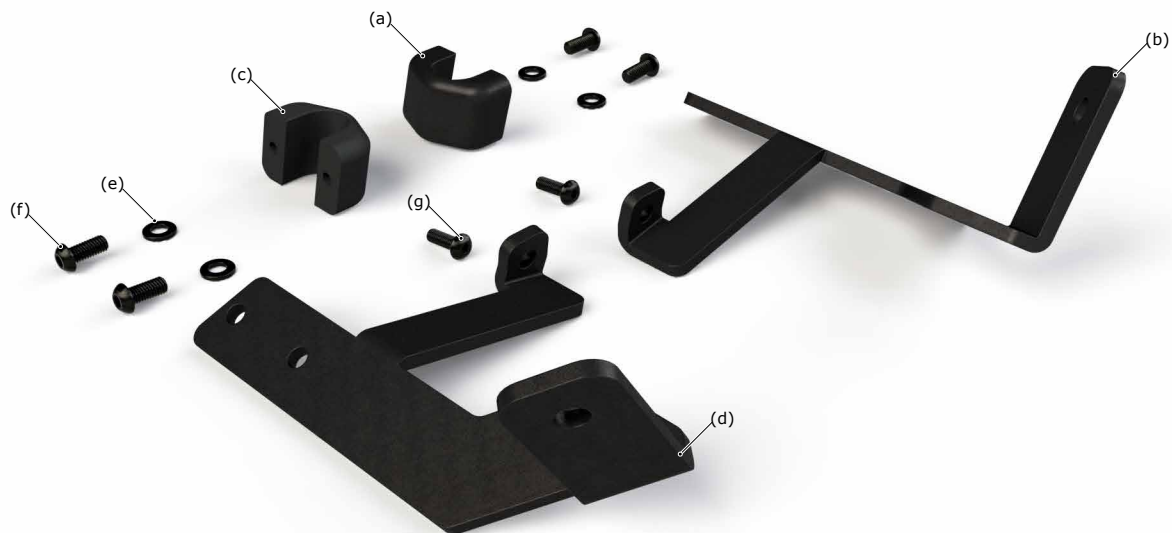

### Kit Contents

- (a) LHS Clamp.....Qty 1
- (b) LHS Bracket.....Qty 1
- (c) RHS Clamp.....Qty 1
- (d) RHS Bracket.....Qty 1
- (e) M6 Washer DIN 125.....Qty 4
- (f) M6x14 ISO 7380.....Qty 4
- (g) M5x16 ISO 7830.....Qty 2

**Tools Required:** T25 Torx , 4mm Allen , 3mm Allen

# 1. Installing The Light Mount

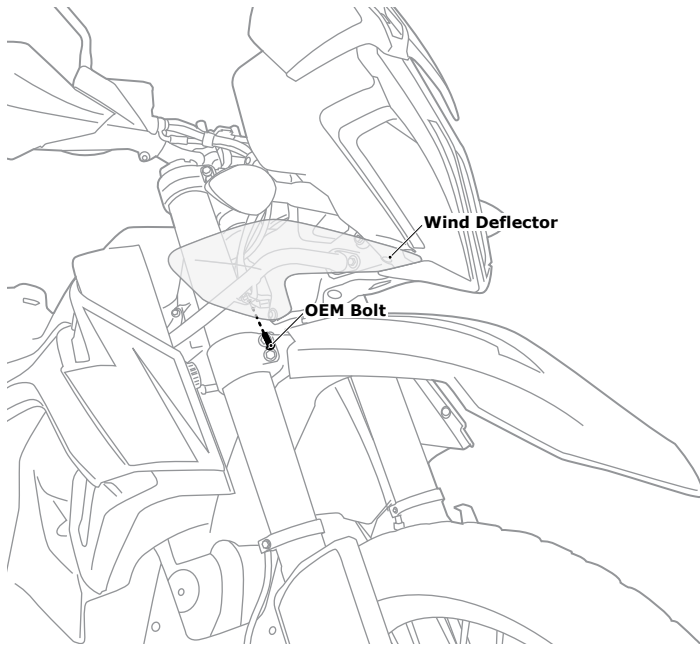

## 1 - Remove OEM Hardware

The following steps reference installing the right hand side Light Mounting Bracket. Simply repeat the steps using the remaining components to install the left hand side Light Mounting Bracket.

**Step One:** Use a T25 Torx driver to remove the rear bolt from the wind deflector.

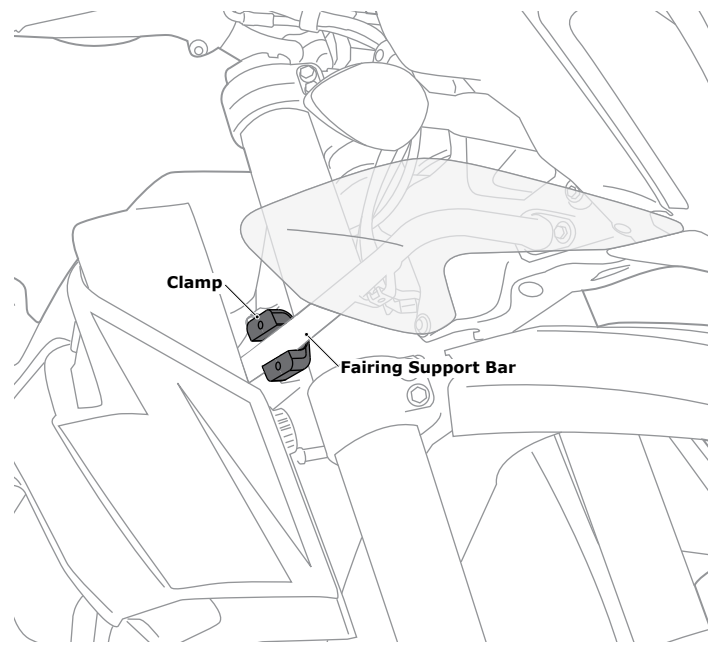

## 2 - Place The Clamp

**Step One:** Place the clamp (c) over the front fairing support bar with the threaded holes facing out.

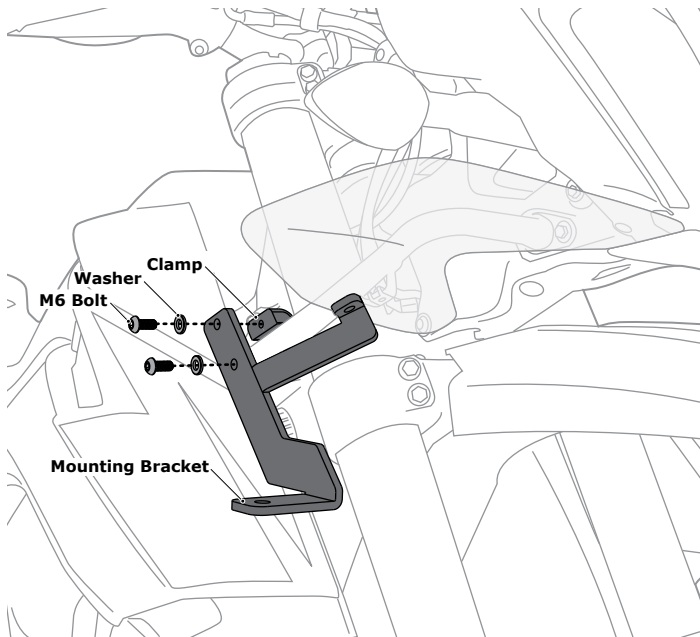

## 3 - Attach The Bracket To The Clamp

**Step One:** Use the M6 Bolts (f) and Washer (e) to attach the Light Mounting Bracket (d) to the Clamp (c). Leave the bolts loose so that the assembly can be easily rotated and slid along the fairing support bar.

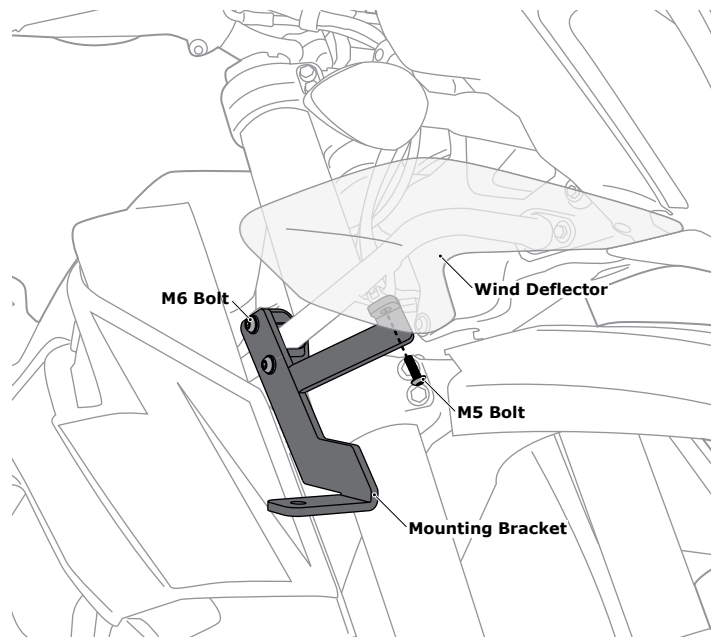

## 4 - Position The Light Mount

**Step One:** Position the assembly on the fairing support bar so that the front mounting point of the Light Mounting Bracket (d) aligns with the rear mounting point of the wind deflector.

**Step Two:** Use the M5 Bolt (g) to attach the Light Mounting Bracket to the rear mounting point of the wind deflector and tighten to 3.5 ft-lbs.

**Step Three:** Fully tighten the M6 Bolts (f) to 6.5 ft-lbs.

Repeat Section 1-4 on the left hand side of the motorcycle using the remaining components.