



**KAOKO™ THROTTLE STABILIZER KITS:**  
**KBBHND100**

RSA Registered Designs  
No. A2007/00202 No. A2007/00205  
No. A2007/00203 No. A2007/00206  
No. A2007/00204 No. A2007/00207

Patents  
"U.S. Pat. No. US D593,462 S"  
"U.S. Pat. No. US D593,463 S"  
"U.S. Pat. No. US D593,464 S"

**For Models HONDA**  
**CB500 XA (2016-)**  
Fitted with BHG-055 Barkbusters

**Items Included in your kit**  
End Weight • Friction Nut • TH-TW103 Thrust washer • 2mm Allen Key  
Fitting Instructions

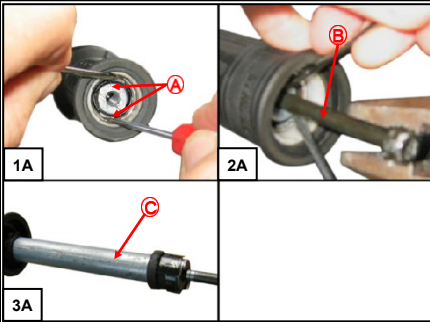

- A** — Two spring Tabs
- B** — Bar-weight retaining screw
- C** — Handlebar insert

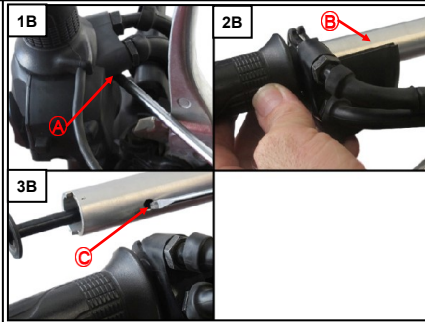

- A** — Clamp Screws
- B** — Handlebar tube
- C** — Handlebar pins

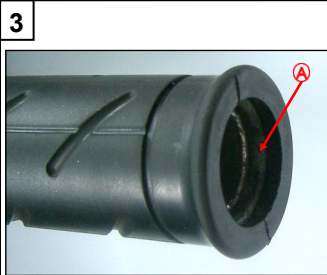

- A** — Plastic throttle sleeve

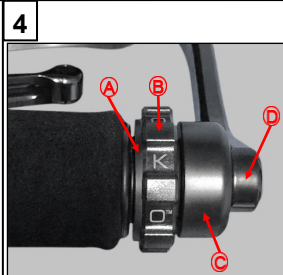

- A** — Thrust Washer
- B** — Friction Nut & Grub Screw
- C** — Kaoko Bar-end weight
- D** — Hand Guard Bracket

**DISCLAIMER: NO RESPONSIBILITY ACCEPTED FOR NON-ADHERENCE TO THESE INSTRUCTIONS**

**KAOKO™ Safety Warning:**

The KAOKO™ Throttle Stabilizer is an aftermarket accessory. Any misunderstood, abused or incorrectly installed motorcycle accessory is a safety hazard that could cause injury or death. It's the rider's responsibility to understand the operation and purpose for which the KAOKO™ Throttle Stabilizer is designed, namely, for cruising, only when safe to do so. At all other times the control should be disengaged. The KAOKO™ Throttle Stabilizers are to be used only by experienced and responsible riders. See reverse of page for full indemnity.

**Note:** An adjustment to throttle assembly position may be necessary to suit KAOKO™ Throttle Stabilizers. The throttle assembly position on aftermarket bars, and some OEM bars, is adjustable. The assembly can marginally be re-positioned along the handle bars slightly loosening the throttle assembly clamp screws, and then sliding the throttle assembly along the handle bars (left or right). Once done, firmly tighten the clamp screws to OEM torque specifications. This adjustment is generally not necessary.

**Fitting Instructions**

**Step 1**

**Step 1A (recommended):** Pictures 1A to 3A: Remove the Throttle side bar weight. Using two small screw drivers, prize the two spring tabs towards each other and simultaneously pull out the handle bar insert (see pictures 1A, 2A & 3A). Discard handle bar insert.

**Step 1B (optional—if required):** Pictures 1B to 3B: Remove the Throttle side bar weight. Loosen throttle assembly clamp screws and slide throttle assembly off handle bar tubes. Refit central retaining bolt to handle bar insert, depress handle bar insert location pins, and remove entire insert from the handle bars (see picture 1B, 2B & 3B).

**Step 2**

Place plastic thrust washer into end of throttle sleeve (see picture 3 & 4).

**Note:** To enable improved functionality, it is recommended (not essential) to apply very light smear of Automotive grease or Petroleum jelly to the friction face of the thrust washer (See Figure 3 at the back of the page)

**Step 3**

Fit the assembled KAOKO™ Kit fully into the handle bar and place the Barkbuster hand guard bracket onto the bar-end weight as shown in picture 4. Note to keep the 2mm gap between the Friction Nut and the shoulder of the KAOKO™ bar weight.

**Step 4**

Insert and tighten the central retaining screw to secure the entire assembly. It is recommended to use a mild thread locking adhesive to secure a tight fit.

**Step 5**

Carefully set rotational resistance of the friction nut by tightening/loosening the grub screw by small adjustments using the 2mm allen key provided in the Kaoko Kit. Take care not to over tighten risking damage to threads. The nut should have fairly firm rotational resistance.

See under **Maintenance below.**

**Operating Instructions**

The Friction Nut has a **left hand thread**. In readiness for engagement, the Friction Nut must be adjusted so that it makes light contact against the thrust washer.

**To Engage:** While rolling on the throttle, the Friction Nut can be gripped between the small finger and palm of hand. This action tightens the nut and provides sufficient friction to set the throttle to the desired opening.  
(The friction is such that the rider may still open and close the throttle. The throttle simply has a slight rotational stiffness.)

**To Disengage:** While rolling off the throttle, grip the Friction Nut between small finger and palm of hand.

**VERY IMPORTANT!!** The throttle should open and snap closed freely when correctly disengaged.

**Note:** The Grub Screw needs to be set to provide the necessary resistance on the thread of the friction nut (only small adjustments need to be made as to not damage the friction nut threads). This may be adjusted periodically to take up wear.

**Maintenance:** Remove kit annually. Unscrew Friction Nut and brush clean threads with a mild soap. Apply petroleum jelly to threads and assemble. Adjust grub screw to desired operating resistance. (O-Ring cushion: 19.6mm I.D. x 2.4mm section — if replacement is required)